



# CY-EM100/100U

## 1m Range EM Reader

The CY-EM100/100U is an EM/TK reader, able to read passive EM/TK tags from up to 100cm\*. It supports passive standard sized cards, and are also compatible with most controllers in the market. A great solution for locations requiring a decent security and at an affordable price.



**Support protocol** : EM-ID  
**Working frequency** : 125Khz  
**Card Type** : Special EM-ID Card  
**Color** : Dark Grey Color  
**Power Supply** : DC12V, 150mA  
**Reader Dimension** : 230mm × 230mm × 35mm  
**Reading Distance** : 70 - 100cm proximity distance  
**Operating Temp.** : 10°C ~ 70°C  
**Interface** : RS-232, RS485, Wiegand 26/34

(Disclaimer: Specifications are subjected to change without prior notice.)  
\*Reading distance depends on tag used & operating environment



Special EM-ID Middle RangeCard

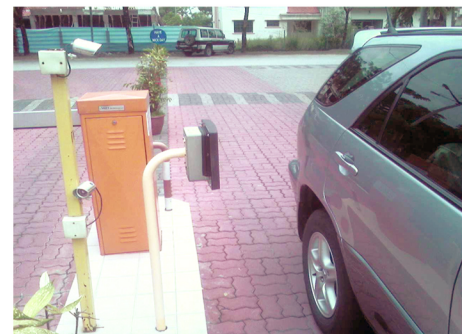

### SCHEMATICS

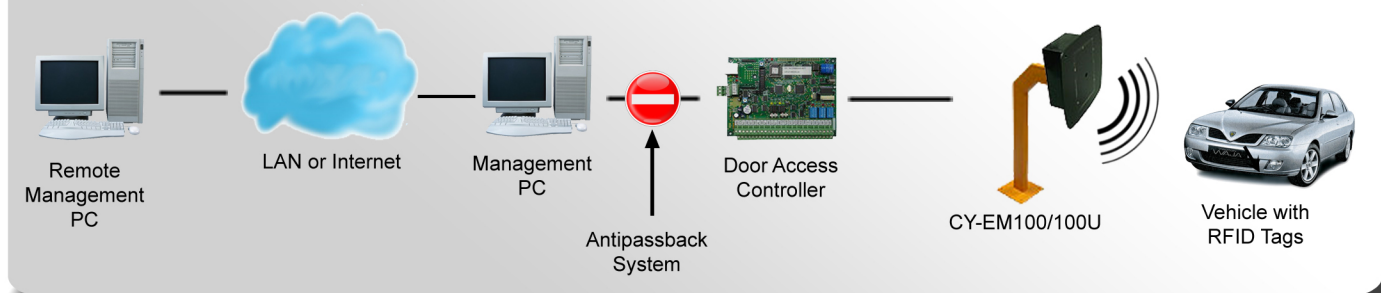

**Authorised Dealer:**