



CY-LR5

UHF Medium Range RFID

The CY-LR5 is a mid-ranged RFID reader, able to read passive RFID tags from up to 8 metres*. It supports passive windshield stickers & standard sized cards and are also compatible with most controllers in the market. A great solution for locations requiring a decent security and at an affordable price.



- Support protocol** : ISO18000-6B / ISO18000-6C (EPC Gen2)
- Working frequency** : ISM 902MHz ~ 928MHz, Or 920MHz ~ 925MHz
- RF Power Output** : 20dBm ~ 30dBm (configured by software)
- Power consumption** : 6W
- Power Supply** : DC+9V, 4A
- Operating Temp.** : -30°C ~ 70°C
- Reader Dimension** : 235mm × 235mm × 50mm
- Tag Read Rate** : Less than 10ms per 64 bits (average read time for single card)
- Weight** : Approximately 1.500kg
- Reading Distance** : 4m ~ 8m (depends on tag used & operating environment)
- Interface** : RS-232, RS485, Wiegand 26/34

(Disclaimer: Specifications are subjected to change without prior notice.)
*Reading distance depends on tag used & operating environment



Standard RFID Card



RFID Windshield Sticker

License-plate Metal Tag



CY-MT10



CY-MT8

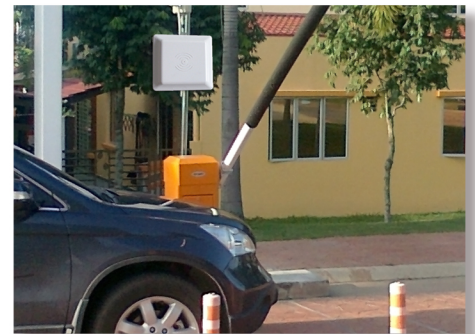

SCHEMATICS

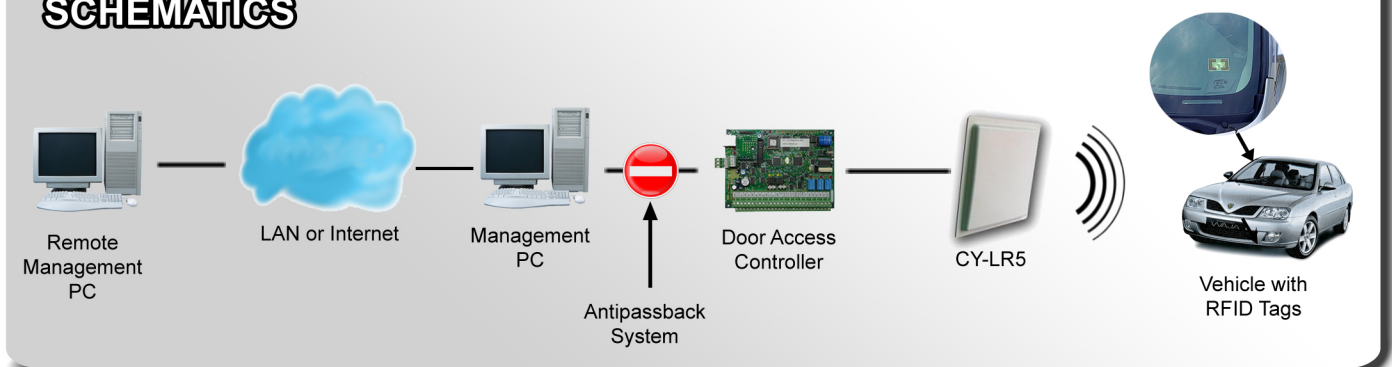

ABGLOBAL SDN. BHD.

51A, 1st Floor, Jalan Kenari 17F, Bandar Puchong Jaya, 47100 Puchong, Selangor Darul Ehsan, Malaysia.

Tel: 603-8075 2263 Fax: 603-8070 4487 H/P: 012-389 6301

Website: www.abglobal.com.my

Email: enquire@abglobal.com.my